

CUSTOMER NAME: .....

ACK No. ....

SALESMAN: .....

**GATE HANDING & OPENING:**

The handing of the gate is determined by the position of the hinges when the gate is viewed from outside. Hinges are always on the opening side of the gate.

\* **STEP 5:** Please tick appropriate box for desired gate fitting option.

**OPTION 1: UNFITTED GATE(s).**

For fittings to be supplied separately.

Please state which side you plan to hang the gate so we can brace the gate correctly. (See hanging options below)

Left Hand Hang  OR Right Hand Hang

**OR**

**OPTION 2: FITTED GATE(s).**

Please tick appropriate box for desired hanging & opening.

**A. Standard Left Hand Hang Opening Inwards**

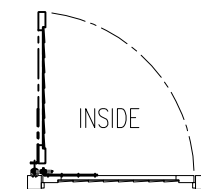

**B. Standard Right Hand Hang Opening Inwards**

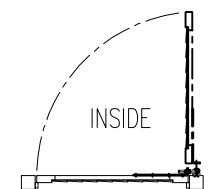

**C. Left Hand Hang Opening Outwards**

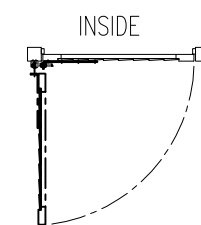

**D. Right Hand Hang Opening Outwards**

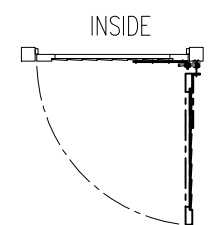

**\*STEP 2.**  
"Actual Gate Width"  
is 20mm less than the  
between posts.

**\*STEP 3.**  
"Total Gate Height"  
Remember not to include  
50mm for Ground Clearance.

**\*STEP 1.**  
"Width Between Posts"

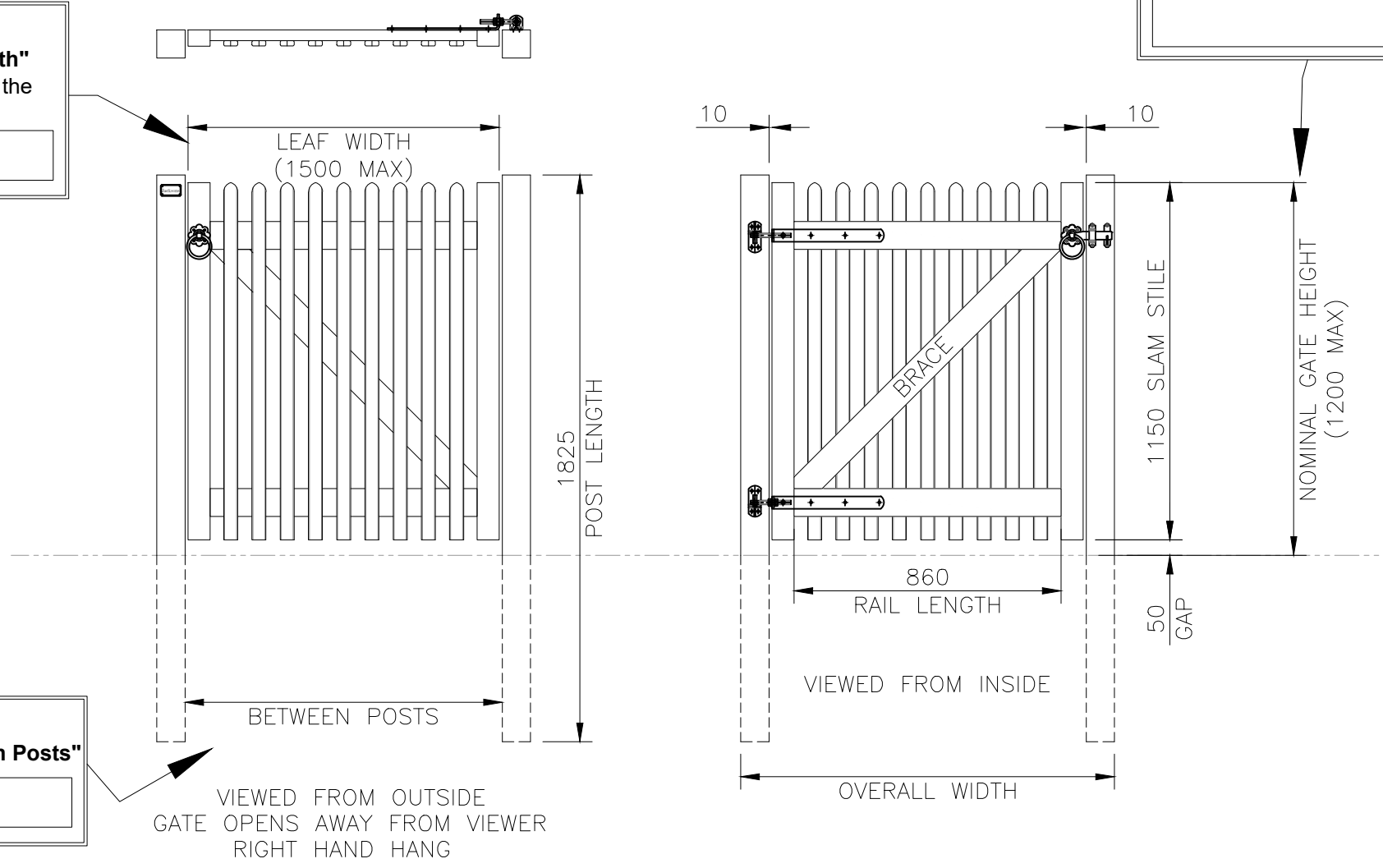

**NOTE:** Please fill in all the required measurements marked with \*.

This order cannot be **Changed** or **Canceled**. Please sign & return the form. Before returning please kindly make sure all the required steps are completed & information is filled in & checked. In case of any queries please contact your salesperson.

**CUSTOMER SIGNATURE:** ..... **DATE:** .....



Stowting Common, Near Ashford,  
Kent. TN25 6BN  
Telephone: 01233 750393  
Fax: 01233 750403  
www.jacksons-fencing.co.uk  
www.jacksons-security.co.uk

DO NOT SCALE – IF IN DOUBT ASK

Drawn HB  
Date 10/05/2018  
Checked ALI  
Size A3 Scale NTS U.O.S

TITLE ORDER FORM FOR MITRE GATES

CUSTOMER MANUFACTURE TOLERANCE ±5mm  
ACK No.

Drawing No. J7/01320

This Drawing Is The Property Of H.S. Jackson & Son (Fencing) Ltd, And May Not Be Copied Or Reproduced In Any Way Without Prior Written Permission.

10/05/2018 ORIGINAL ISSUE